

MODEL: 4LETS6030

ALL ACCESSORIES OPTIONAL

Remodeler

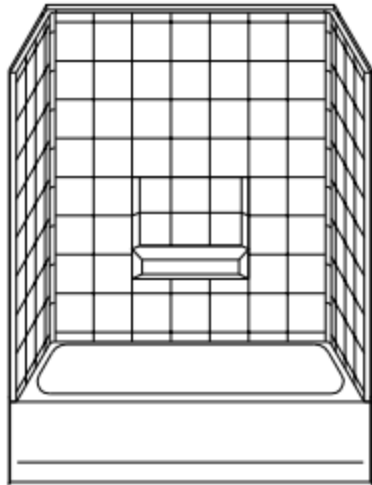

PERSPECTIVE VIEW - N.T.S.
MODEL SHOWN HERE AS: RIGHT HAND

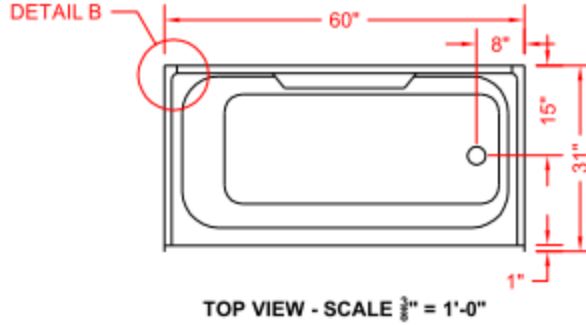

TOP VIEW - SCALE $\frac{3}{8}$ " = 1'-0"

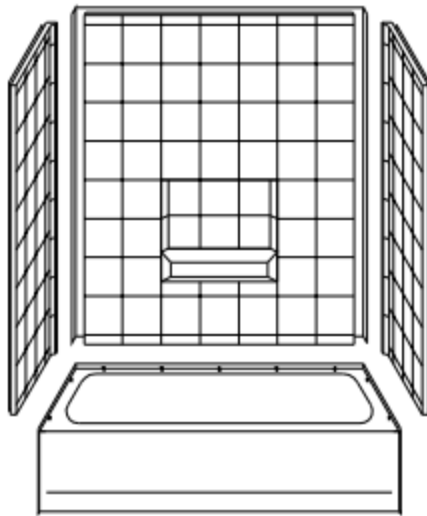

ASSEMBLY VIEW - N.T.S.

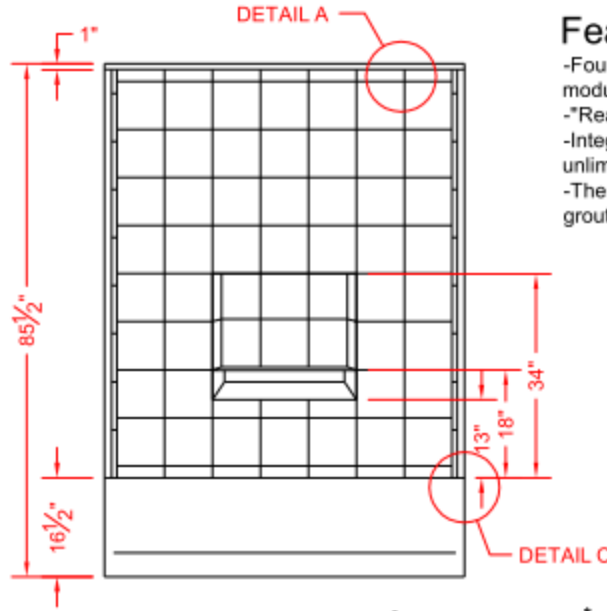

FRONT ELEVATION - SCALE: $\frac{3}{8}$ " = 1'-0"

Features:

- Four-piece gelcoat/fiberglass tub/shower module
- "Real Tile" wall finish, white (standard)
- Integral full wood backing for strength and unlimited accessory placement
- The authentic look of ceramic tile without the grout

* - SEE BACK FOR DETAIL SECTIONS

PRODUCT SPECIFICATIONS:

- Four-piece tub/shower module shall be constructed of gelcoat/fiberglass with full integral plywood backing in the walls
 - Door opening: 57" x 67-3/4"
 - Rough-In: Stud opening +1/4" -0" Nominal Dimensions.
- C.S.I. FORMAT SPECIFICATION TEXT AVAILABLE

PRODUCT INFORMATION:

- Accessories: Factory installed, unless prone to damage during installation/shipping. Polished chrome/satin stainless standard, others available.
- Colors: White as standard, others to match any major fixture manufacturer, also available with sprayable solid surface in many colors

ACCESSORIES:

INSTALLED BY OTHERS:

- Grab bar
- Seat, folding
- Mixing valve, pressure balanced, lever handle, preplumbed tree to supply elbow
- Curtain and rod

CODES:

- Designed and manufactured in compliance with the following standards and codes:
- A.N.S.I. Z1241.2 Standards for plastic Bathtubs and Showers
 - I.P.C. International Plumbing Code
 - U.P.C. Uniform Plumbing Code

NOTICE OF LIMITATION:



www.orcahealthcare.com
1-888-761-9451

Remodeler

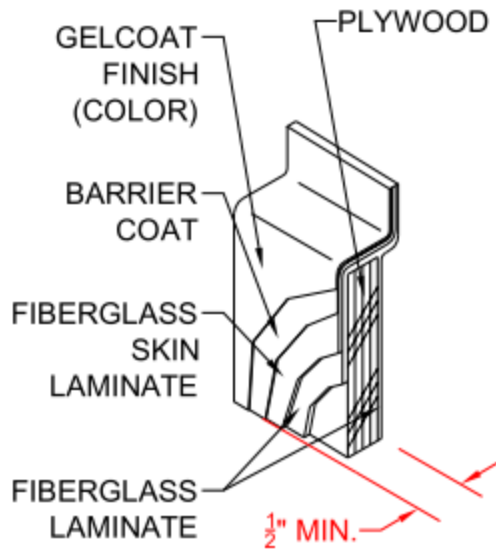

DETAIL A - SCALE N.T.S.
WALL SECTION DETAIL

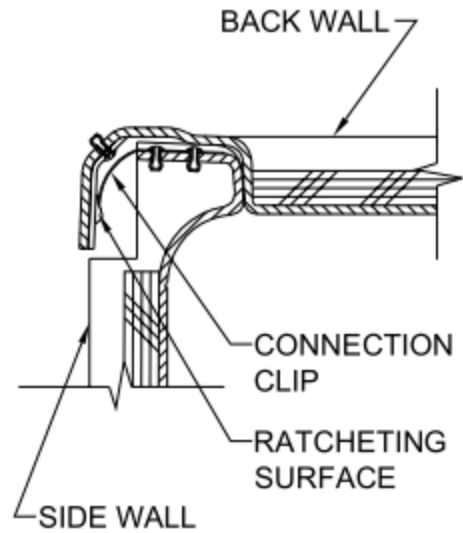

DETAIL B - SCALE N.T.S.
WALL JOINT DETAIL

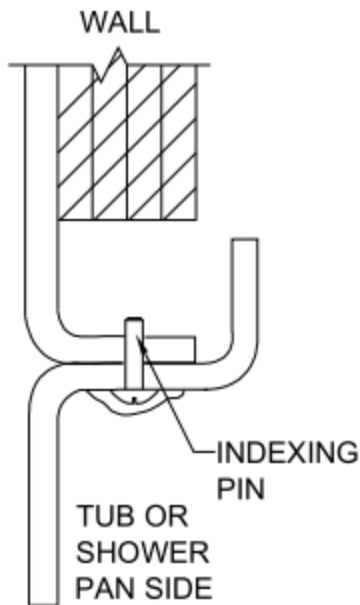

DETAIL C - SCALE N.T.S.
WALL/TUB JOINT DETAIL

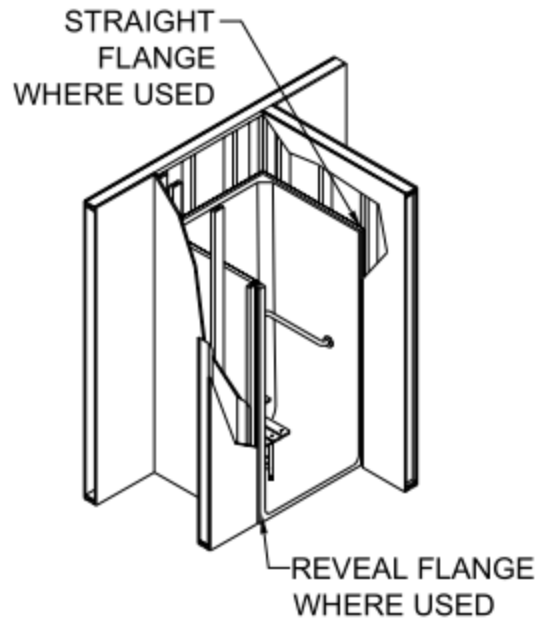

DETAIL D - SCALE N.T.S.
TYPICAL FRAMING DETAIL